

How to Include Sign Language in a Production — Option 1

Create a layout set tailored for this setup (see screenshots). The example uses Talk Show layouts, but the same approach applies to Presentation and Panel Discussion formats.

- Start with a 2-split layout (without interpreters). Ensure that the camera boxes match the exact pixel placement you'll use when interpreters are added.
- Then create a 3-split with camera box number three where you want the interpreter to appear.
- Then create a 4-split with camera box number 4 in a layer on top of number three.
- Interpreter 1 is now speaker 3.
- Interpreter 2 is now speaker 4.
- Now select Manual mode, 4 split, with speakers 1 and 2 in boxes 1 and 2.
- Then select interpreter 1 as speaker 3 and interpreter 2 as speaker 4 in the pre-meeting settings.

During the production, Interpreter 1 can keep their camera on at all times. When Interpreter 2 activates their camera, it will appear on top of Interpreter 1's feed. Interpreter 1 will remain hidden until Interpreter 2 turns their camera off again.

This way, the switch between interpreters will be very seamless.

You can now go into different layouts in the control room and switch people in manual mode, or create segments with different people.

[Example video](#)

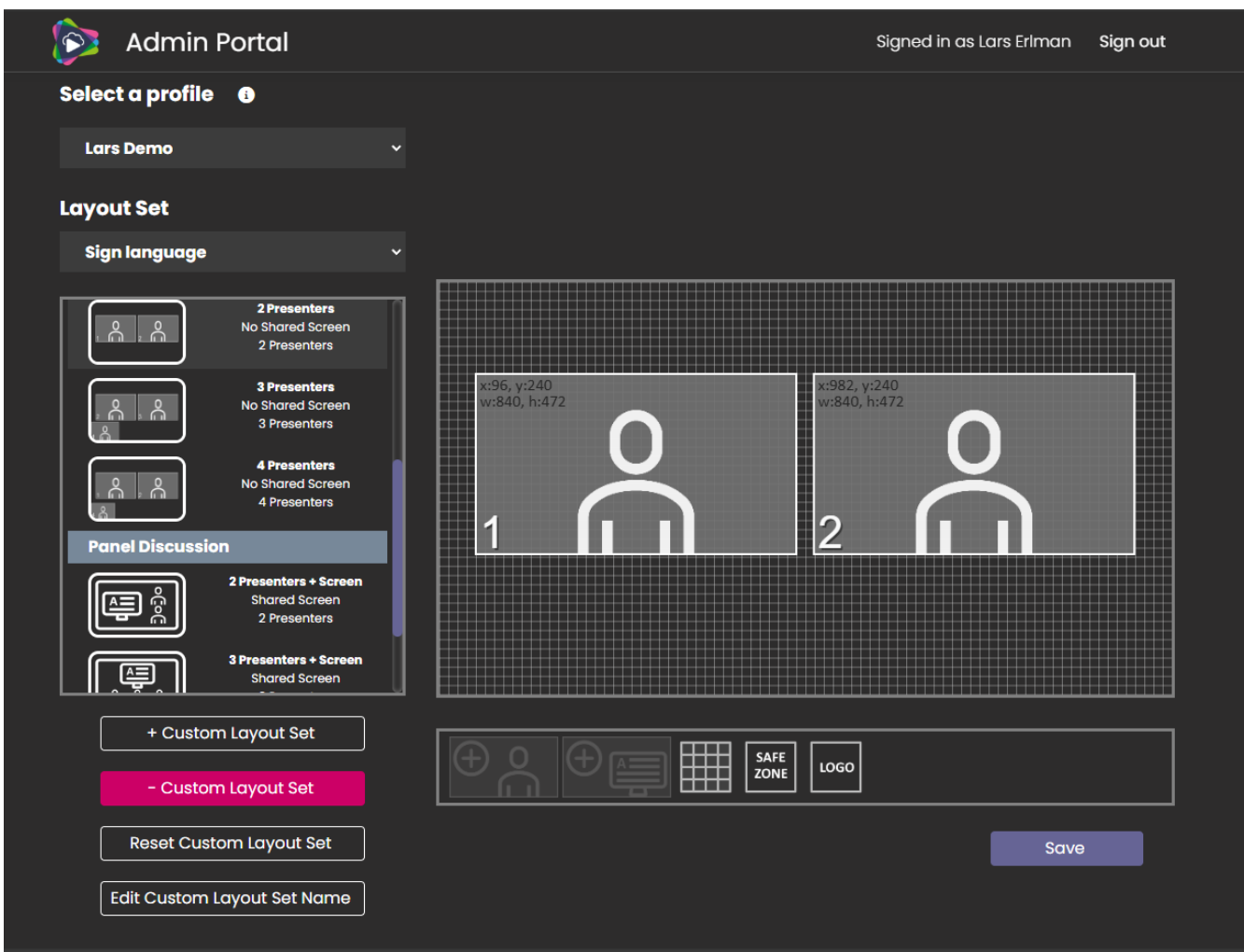

2-split layout

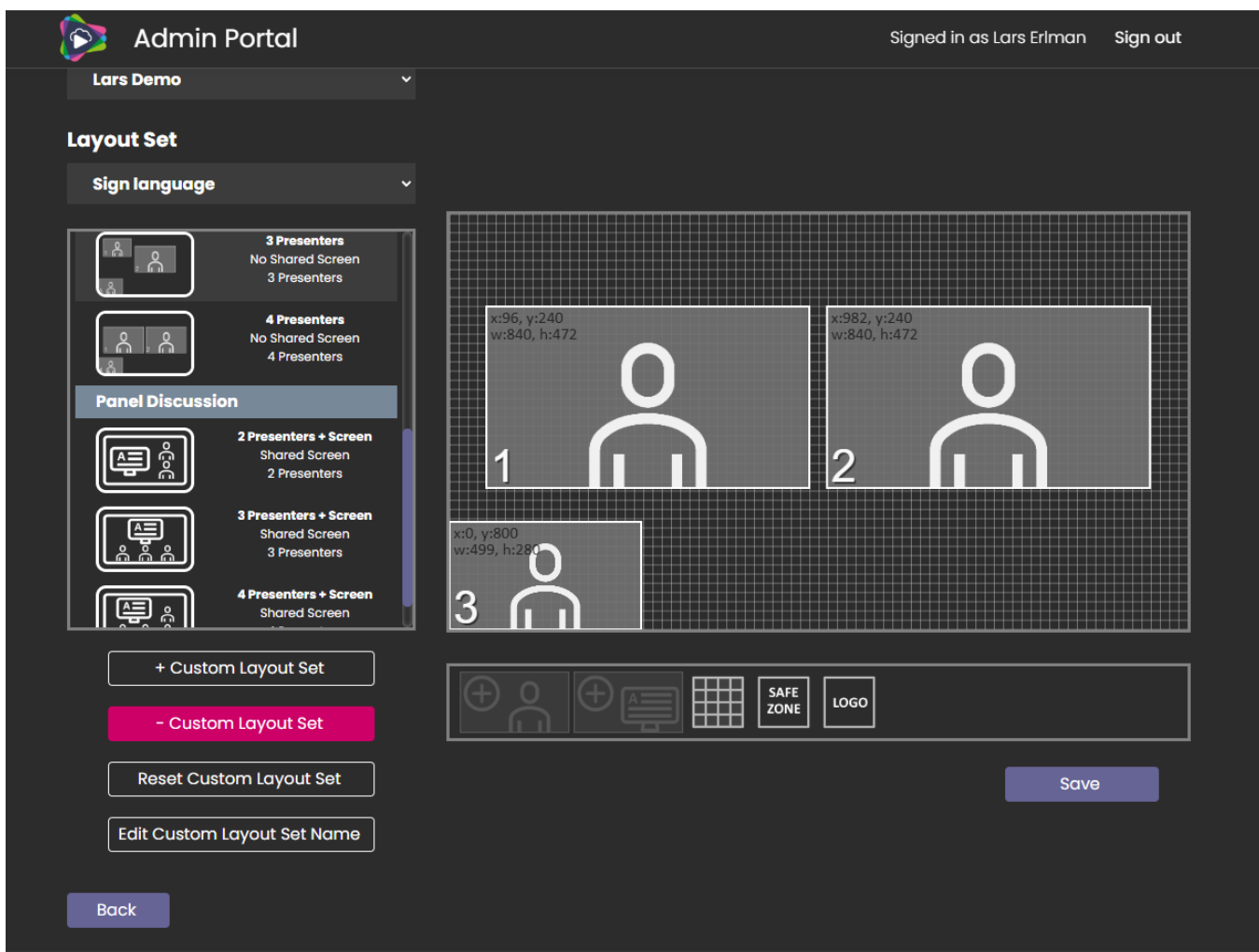

1 interpreter

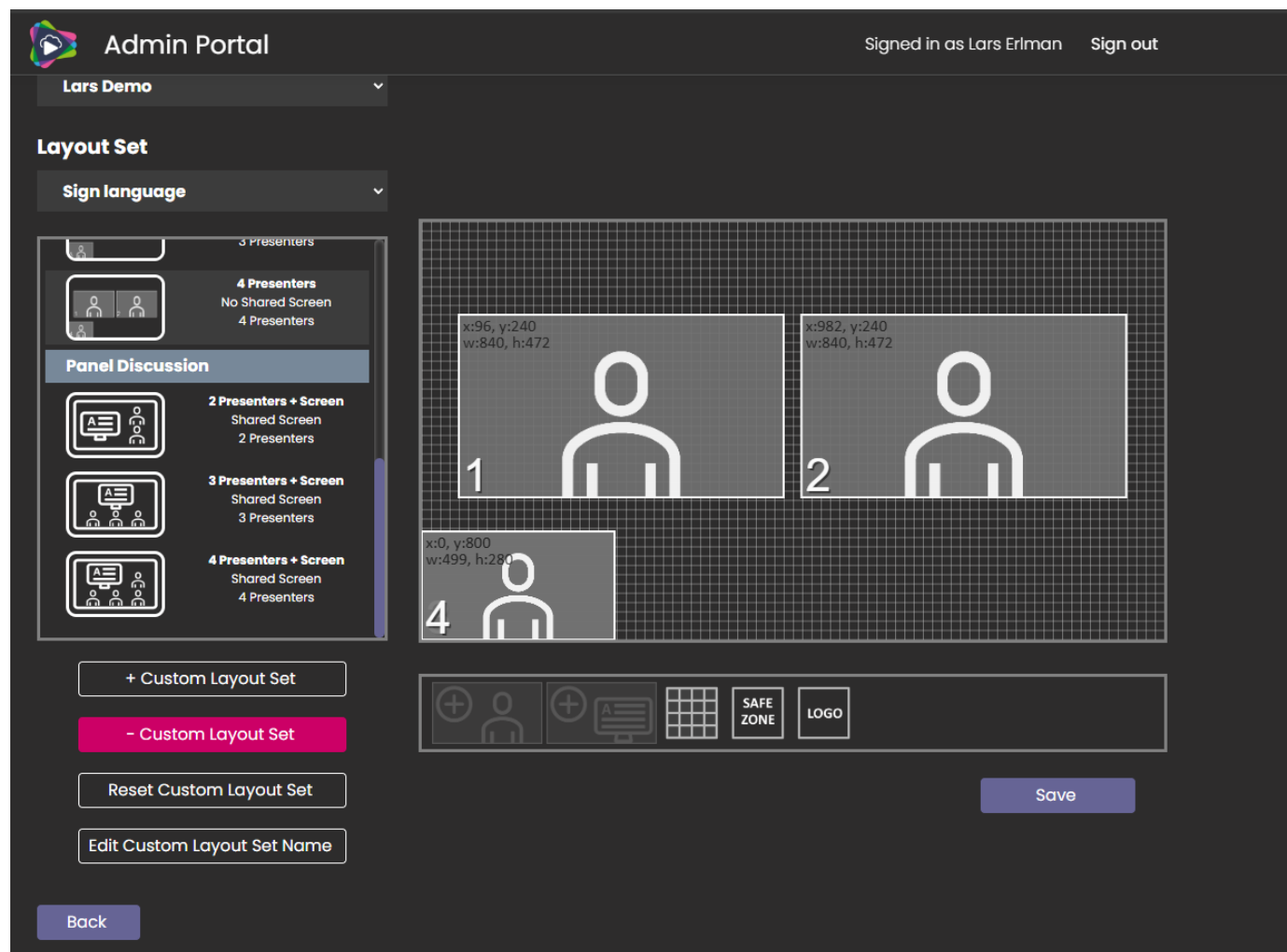

2 interpreters

How to Include Sign Language in a Production — Option 2

- You run a standard production using AI Producer and stream it to a second Teams meeting via RTMP.
- In the second Teams meeting, add AI Producer, select RTMP as a speaker source, and then layer the interpreters in the same way as described in Option 1.

This setup results in a production that can be broadcast to any destination. In the example to the right, the interpreters are positioned outside the main production frame. However, you can also place them picture-in-picture if that better suits your needs.

With Option 2, you can have one destination that includes interpreters and another that does not. This also allows you to generate recordings both with and without interpretation.

